

Emergency Instrumental/Vocal Provision Guidance for Parents

Fixing Valves on Brass Instruments

Brass instruments require regular maintenance, ensuring they continue to work. This is vitally important with their valves, ensuring that they do not get sticky or stuck down. The valves (see picture to right) are pressed in differing combinations, enabling the instrument to play a range of different notes. Therefore, they need to move freely in order to play the instrument.



Valves 1, 2, 3

Please see below the following guidance on how to ensure the valves are kept in good working order. Before doing anything, please read the following important advice:

1. Be aware that valves commonly have numbers on the top half of the valve, indicating its valve number (1,2 or 3).
2. Valve 1 is nearest the mouthpiece, Valve 3 is furthest away from the mouthpiece with Valve 2 always being in the middle.
3. When you take out the valve, **please identify which direction this number is facing**, because if you put the valve in the wrong way, you will get a blocked sound, because air cannot travel fully through the instrument.
4. When putting the valve back in to the instrument, ensure that this is done gently. Please ensure this is not forced back in, potentially damaging the instrument.

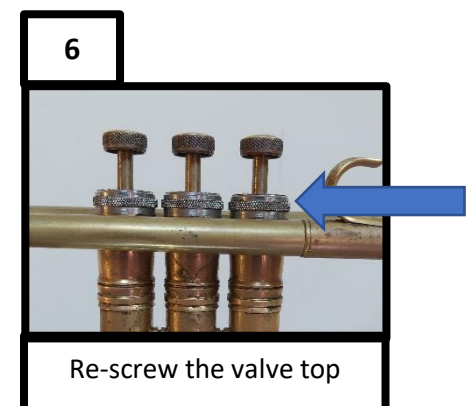
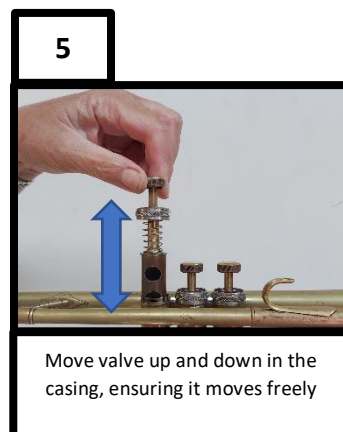
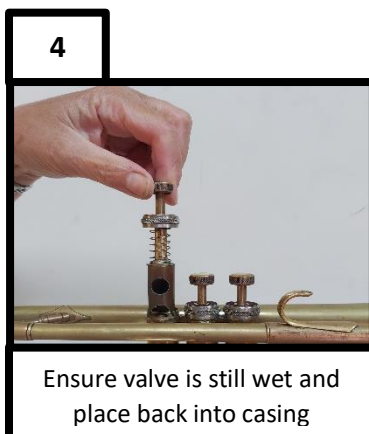
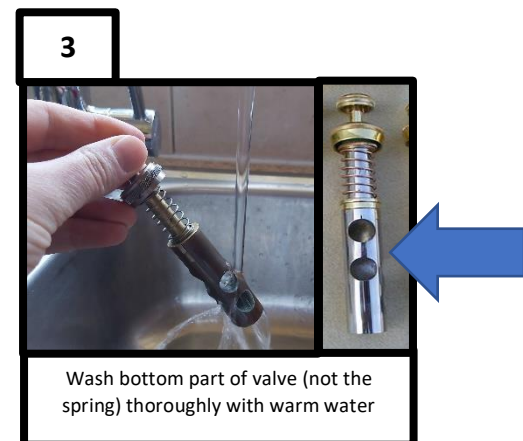
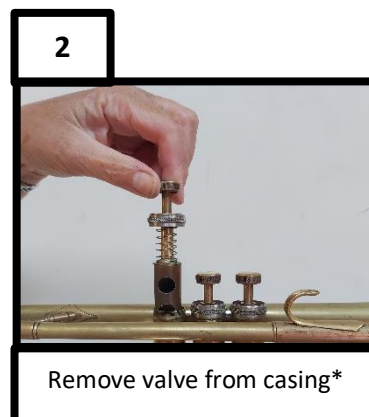
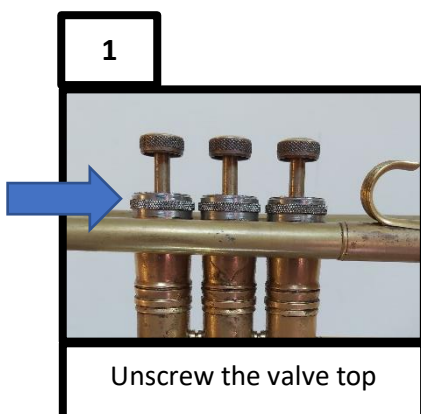

If you are experiencing any problems with the valves between lessons, please feel free to contact me on:
Mark.Lowe2@centralbedfordshire.gov.uk